

Flat Point

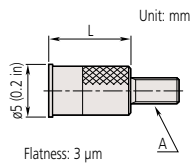

A: M2.5x0.45

Order No.	L
131365	8
21AAA340	10



131365

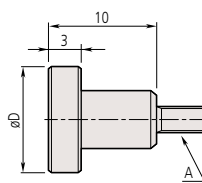

A: M2.5x0.45

Order No.	øD
101117	10
21AAA341	15
21AAA342	20
21AAA343	25
21AAA344	30



101117

Flatness: 5 µm

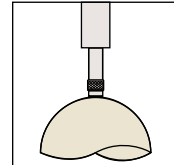

A: 4-48UNF

Order No.	L (in)
133017	5/16
21AAA043	1/2
21AAA044	3/4
21AAA045	1

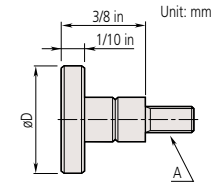

A: 4-48UNF

Order No.	øD (in)
101188	1/2
101189	3/8

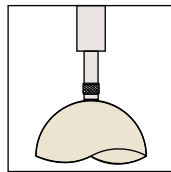

Flat Point (Carbide)

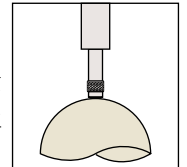
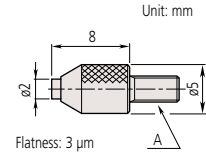

A: M2.5x0.45

Order No.
120056



120056

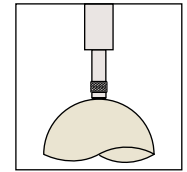
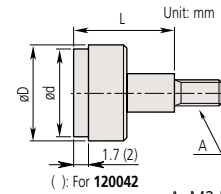

A: M2.5x0.45

Order No.	øD	ød	L
120041	5.2	4.3*1	5
120042	7	6.5*1	10
120043	10.5	9.5*1	10
21AAA345	17	15*2	10
21AAA346	22	20*2	10
21AAA347	27	25*2	10
21AAA348	32	30*2	10



120043

Flatness: *1: 3 µm, *2: 5 µm

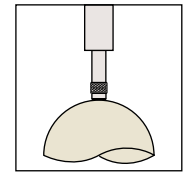
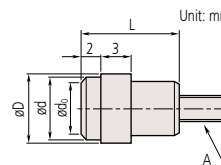

A: M2.5x0.45

Order No.	ød ₀	ød	øD	L
137255	3	6.4	7	10
137399	4.5	8	9	10



137255

Flatness: 3 µm

Needle Point

Suitable for probing the bottom of a groove or hole.

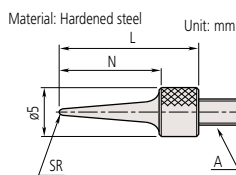

101121

A: M2.5x0.45

Order No.	N	L	SR
101121	11	15	0.4
137413	13	17	0.2
21AAA255	21	25	0.4
21AAA256	31	35	0.4

A: 4-48UNF

Order No.	L (in)	SR (in)
21AAA030	0.6	0.016
21AAA046	1	0.016
21AAA047	1 1/2	0.016
21AAA048	2	0.016

Needle Point (Carbide)

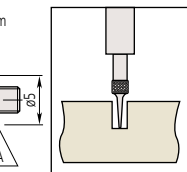
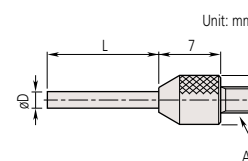

A: M2.5x0.45

Order No.	øD	L
120066	0.45	3
21AAA329	0.45	5
120065	1	3
21AAA330	1	5
21AAA331	1	8
21AAA332	1	10
21AAA333	1	20
21AAA334	1	40
21AAA335	1.5	5
21AAA336	1.5	10
120064	1.5	13
21AAA337	1.5	20
21AAA338	1.5	40
137257	2	8
21AAA257	2	18
21AAA258	2	28
21AAA339	2	40



137257