

Setting Standards for Outside Micrometers SERIES 167

Typical application



Micrometer Inspection Gauge Block Set

Refer to page E-11 for details.

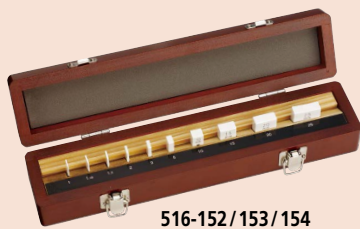

516-152 / 153 / 154



Micro Checker (holder only)
516-607

- Used for adjusting the reference point of outside micrometers.



167-108

SPECIFICATIONS and DIMENSIONS

167-101 to 167-103
167-141 to 167-143

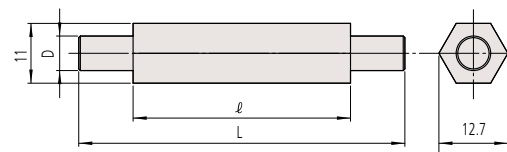

Unit: mm

Metric

Order No.	Length <L> (mm)	Accuracy (μm)	Parallelism (μm)	Flatness (μm)	ℓ (mm)	Diameter <D> (mm)
167-101	25	±1.5	2.0	0.3	18	6.35
167-102	50	±2.0			40	
167-103	75	±2.5			40	

Inch

Order No.	Length <L> (in)	Accuracy (in)	Parallelism (in)	Flatness (in)	ℓ (mm)	Diameter <D> (in)
167-141	1	±0.00005	0.00008	0.000012	18	0.25
167-142	2	±0.0001			40	
167-143	3	±0.0001			40	

167-104 to 167-107
167-144 to 167-147

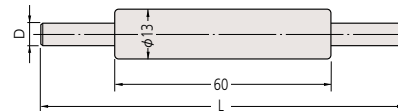

Unit: mm

Metric

Order No.	Length <L> (mm)	Accuracy (μm)	Parallelism (μm)	Flatness (μm)	Diameter <D> (mm)
167-104	100	±3	2.0	0.3	7.9
167-105	125	±3.5			
167-106	150	±4			
167-107	175	±4.5			

Inch

Order No.	Length <L> (in)	Accuracy (in)	Parallelism (in)	Flatness (in)	Diameter <D> (in)
167-144	4	±0.0001	0.00008	0.000012	0.31
167-145	5	±0.00015			
167-146	6				
167-147	7				

167-108 to 167-119
167-148 to 167-159

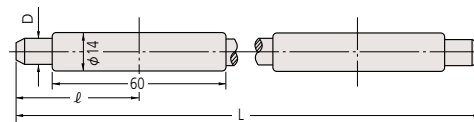

Unit: mm

Metric

Order No.	Length <L> (mm)	Accuracy (μm)	Parallelism (μm)	Flatness (μm)	ℓ (mm)	Diameter <D> (mm)
167-108	200	±5.0	2.0	0.3	47	9.4
167-109	225	±5.5			47	
167-110	250	±6.0			52	
167-111	275	±6.5			57	
167-112	300	±7			64	
167-113	325	±7.5			69	
167-114	350	±8			74	
167-115	375	±8.5			80	
167-116	400	±9			85	
167-117	425	±9.5			90	
167-118	450	±10			95	
167-119	475	±10.5			101	

Inch

Order No.	Length <L> (in)	Accuracy (in)	Parallelism (in)	Flatness (in)	ℓ (mm)	Diameter <D> (in)
167-148	8	±0.00015	0.00008	0.000012	47	0.37
167-149	9	±0.0002			47	
167-150	10	±0.0002			52	
167-151	11	±0.0002			57	
167-152	12	±0.00025			64	
167-153	13	±0.00025			69	
167-154	14	±0.00025			74	
167-155	15	±0.00025			80	
167-156	16	±0.00025			85	
167-157	17	±0.00025			90	
167-158	18	±0.00025			95	
167-159	19	±0.0003			101	